

L TYPE CORNER EDGE CARTON SEALER

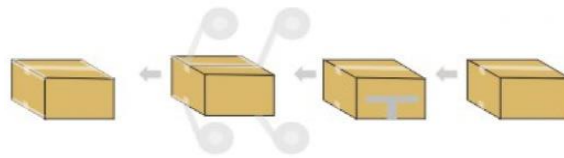

Corner sealing machine that can turn 90 degrees is suitable for small size cartons and can be customized

Space required for machine installation

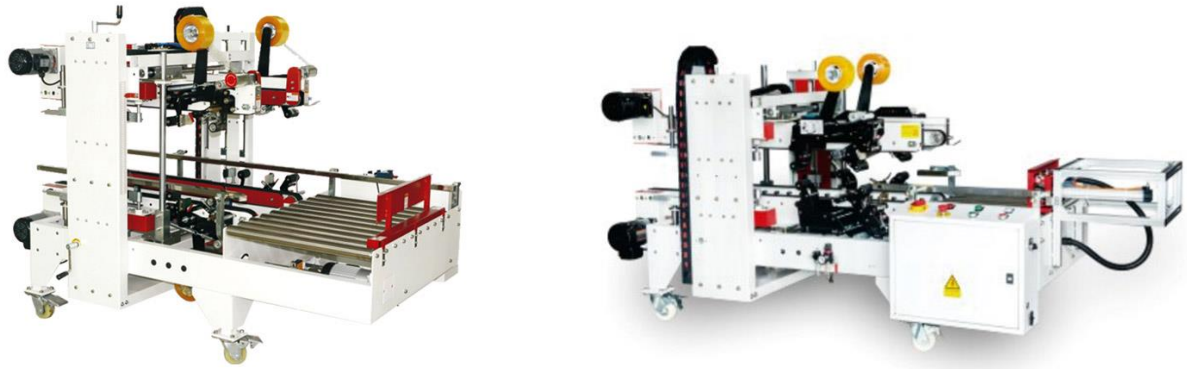
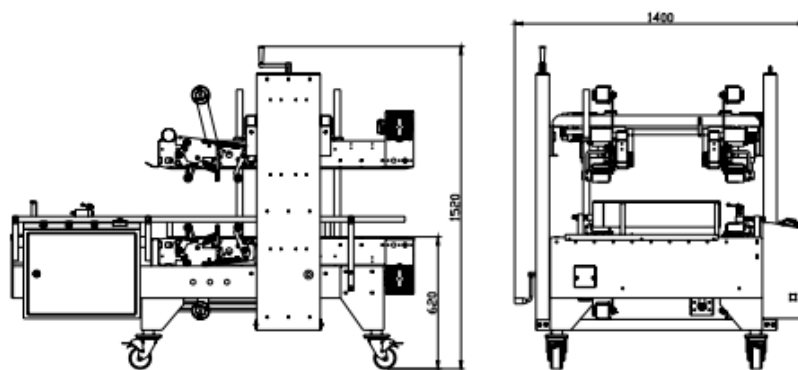

Space distance of at least 800mm shall be reserved around the machine, and 800mm shall be increased for the part of feeding the carton according to the width spacing of the carton. For the personnel to operate the machine, adjust, clean and other work.

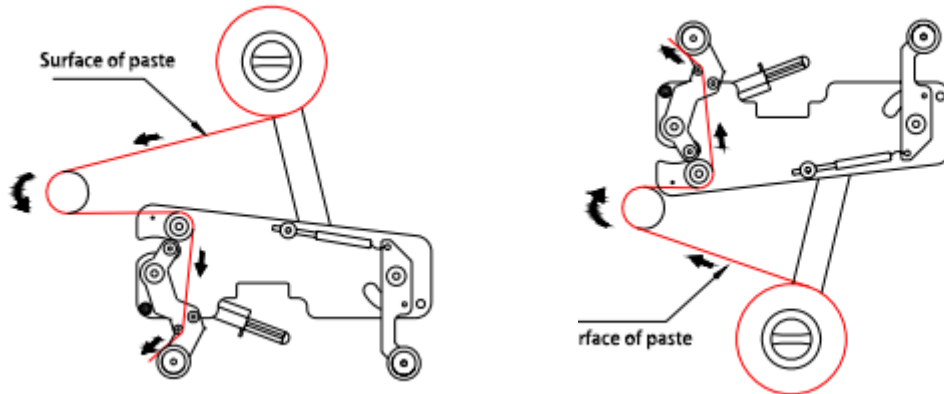

Installation and insertion of tape

Installation and Adjustment

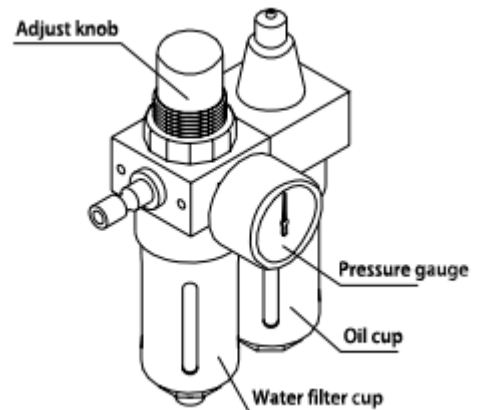
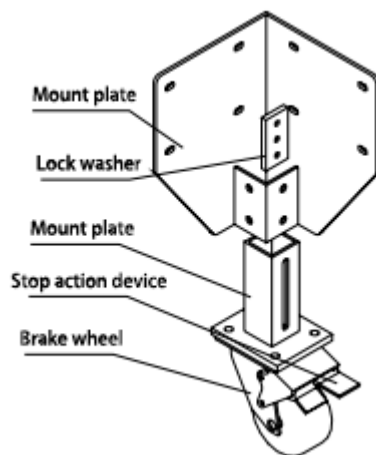

Note:

Do not switch on the power supply before installation and adjustment.

Step 1 (Adjust the height of the workbench)

Place the devices in the corresponding working space and adjust them as required
Set the working surface height.

Specific operation: loosen the "elastic washer", adjust the inner three feet ",
After reaching the required operating height, lock the "elastic nut" and press down the
"stop" to make the machine fixed.

Step 2 (Adjust the main air source)

Connect the air source, lift the adjusting knob, turn clockwise to increase
Increase the pressure, turn counterclockwise to reduce the pressure, observe the

pressure gauge value is 5-6kg/ cm², after adjustment, lock the knob.

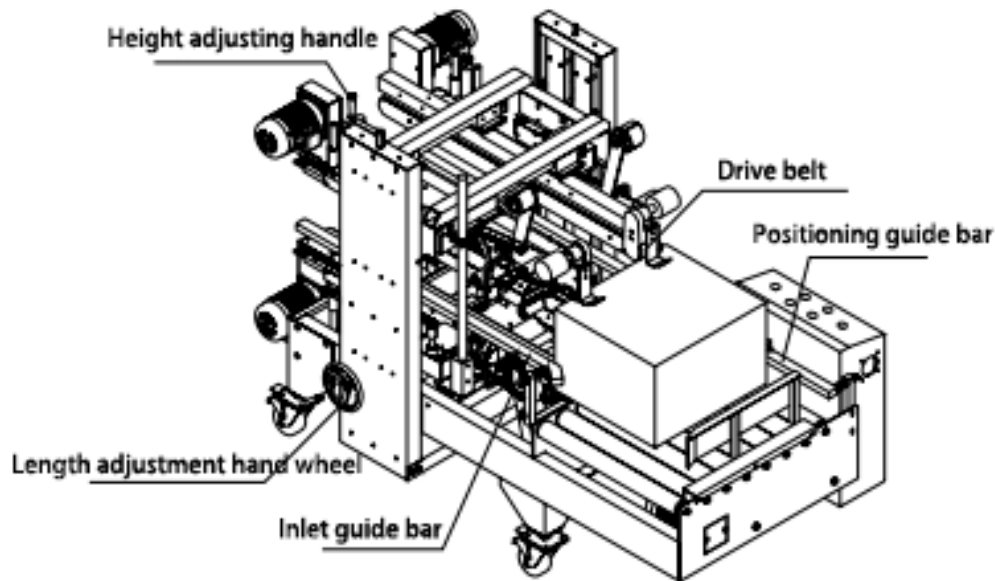

Step 3 (Length Adjustment)

Place the carton on the drum table and lean against the "positioning guide bar".
Shake the "Length adjustment handwheel" until the "inlet guide bar" is just right
Close to the carton.

Step 4 (Height Adjustment)

After the length is adjusted, shake the "height adjustment handle" to make
The "upper drive belt" just touches the top of the carton and is delivered normally.

Cleaning and lubrication

Maintenance personnel in the repair, maintenance of the machine must be studied first

This manual can be used for repair and maintenance.

Be sure to turn off and cut off the power supply before repair and maintenance

Prevent accidental power supply, resulting in danger.

If different sizes of tape must be used, follow the instructions

The parts list in the book, purchase different tape parts of the zero A.

Keep the machine as clean as possible, remove the movement and belt

Dirt, waste, tape, etc. attached to the rotating part.

To maintain the service life of the blade, it is recommended to check the knife before
leaving work

If the piece is too much adhesive, clean it up and wipe 30#

The oil

All movable parts of a machine for proper operation

All parts must be lubricated with 30# oil once a week.