

BAGGAGE WRAPPING MACHINE

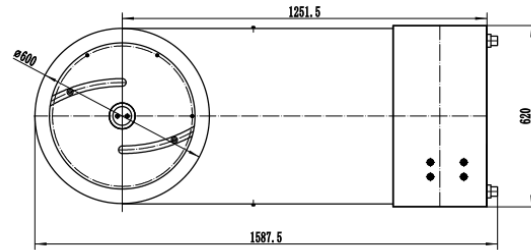

Airport luggage wrapping machine is widely used not only to wrap the cargo but also to secure wrapped items from opening, pilferage, tampering, damage in transport, smuggling and theft of baggage or cargo. While theft will always be possible the damage to the wrapping layer will immediately put on alert transportation companies and airline personnel. Especially baggage wrapping in airports, sea-ports, bus, and train terminals add to security, removing possibility of placing in the packages any contraband, dangerous materials, drugs or explosive. Stretch wrapping machines, using transparent stretch film allow easy verification of the content packaged on pallets and identification of baggage at the destination.

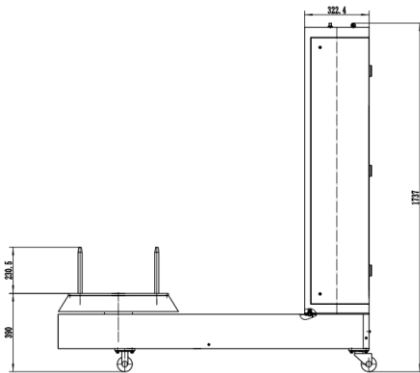

- Powered pre-stretch mechanism up to 300 % for material savings
- Adjustable rotary spins for flexible baggage acceptance
- Pre-selected counter for the numbers of the layers of folio, wrapped over the baggage and automatic stop
- Soft-start baggage rotation and automatically stop functions
- Modern design and many color options, made in harmony with the airport interior
- Stainless steel frame as standard
- Here are three Luggage wrapping machine for users to choose from

NEW BAGGAGE WRAPPING MACHINE

Model	Parameters	Image
Wrapping Size (L*M)	(250-1200)*(220-480)mm	
Wrapping Height	(400-950)mm	
Turntable rotation speed	3-20 rpm adjustable	
Working Capability	10-60pieces/hour	
Loadable Weight	100kg	
Power/voltage	1.2kw/220v	
Weight	220kg	
Shape dimension	1650*600*1670mm	
Weigh the luggage weight	Optional	
Play the video	Optional	
Film pre-stretch	150-250%	

Small baggage wrapping machine

Model	Parameters	Image
Wrapping Size (L*M)	(250-600)*(220-480)mm	
Wrapping Height	(400-500)mm	
Turntable rotation speed	3-20 rpm adjustable	
Working Capability	40-100pieces/hour	
Loadable Weight	100kg	
Power/voltage	0.75kw/220v	
Weight	200kg	
Shape dimension	1200*600*950mm	
Weigh the luggage weight	Optional	
Film pre-stretch	150-250%	

Baggage wrapping machine

Model	Parameters	Image
Wrapping Size (L*M)	(300-800)*(200-400)mm	
Wrapping Height	(400-500)mm	
Turntable rotation speed	3-20 rpm adjustable	
Working Capability	40-100pieces/hour	
Loadable Weight	100kg	
Power/voltage	0.75kw/220v	
Weight	220kg	
Shape dimension	1650*600*1200mm	
Weigh the luggage weight	Optional	
Film pre-stretch	150-250%	